

# Folino Floor Plan

In Riverview Estates from \$692,900

## PLAN DETAILS

Pricing from \$692,900

3 Beds
 2.0 Baths
 3,134 Sq Ft  
 1 Story
 2 Car Garage



Craftsman Elevation - Side Entry

The Folino is an elegant ranch-style home with a well-planned design and alluring exterior. Step into the welcoming Foyer and continue to a private Study, two Bedrooms, and shared Hall Bath that set the tone for this sophisticated abode. The heart of this home is the open-concept Great Room, Kitchen, and Dining Room that making entertaining an effortless experience. The Kitchen boasts a large island with an overhang, offering ample seating for guests, a convenient corner pantry, and plenty of countertop space. The Great Room is bathed in natural light and leads to your backyard through a sliding door. Relax in style in your very own private haven as you enter the Owner's Suite, boasting a spacious walk-in closet and a luxurious ensuite Bath with a double vanity, linen closet, large shower, ... Read More at [tuskeshomes.com](https://tuskeshomes.com)

## PLAN FEATURES

- 3 Bedrooms
- 2 Bathrooms
- 2-Car Garage
- Starting at 3134 Square Feet
- Partially Finished Basement
- Kitchen Island with Granite or Quartz Countertops
- Stainless Steel Range/Oven, Microwave, and Dishwasher
- Gas Fireplace in Great Room
- Ranch Style Floor Plan
- Mudroom
- Study
- Private Owner's Suite

# Folino Floor Plan

In Riverview Estates from \$692,900



Cottage Elevation - Side Entry

# Folino Floor Plan

In Riverview Estates from \$692,900



**FOLINO COTTAGE**  
RIVERVIEW ESTATES  
STARTING AT 3134 SF

1ST FLOOR PLAN

# Folino Floor Plan

In Riverview Estates from \$692,900

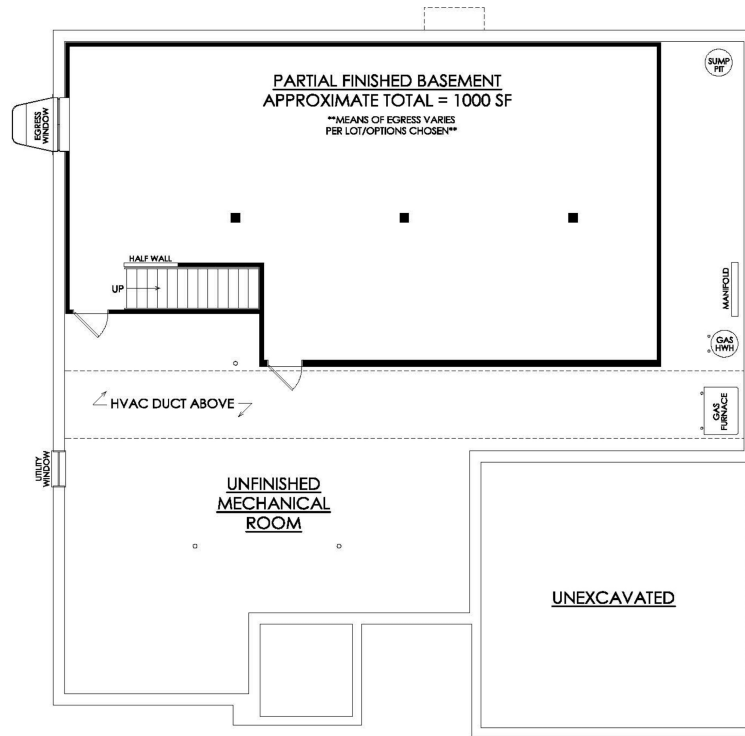

**FOLINO COTTAGE**  
RIVERVIEW ESTATES  
STARTING AT 3134 SF

**FINISHED BASEMENT**

# Folino Floor Plan

In Riverview Estates from \$692,900



**FOLINO CRAFTSMAN**  
RIVERVIEW ESTATES  
STARTING AT 3134 SF

1ST FLOOR PLAN



# Folino

## Floor Plan

In Riverview Estates from \$692,900

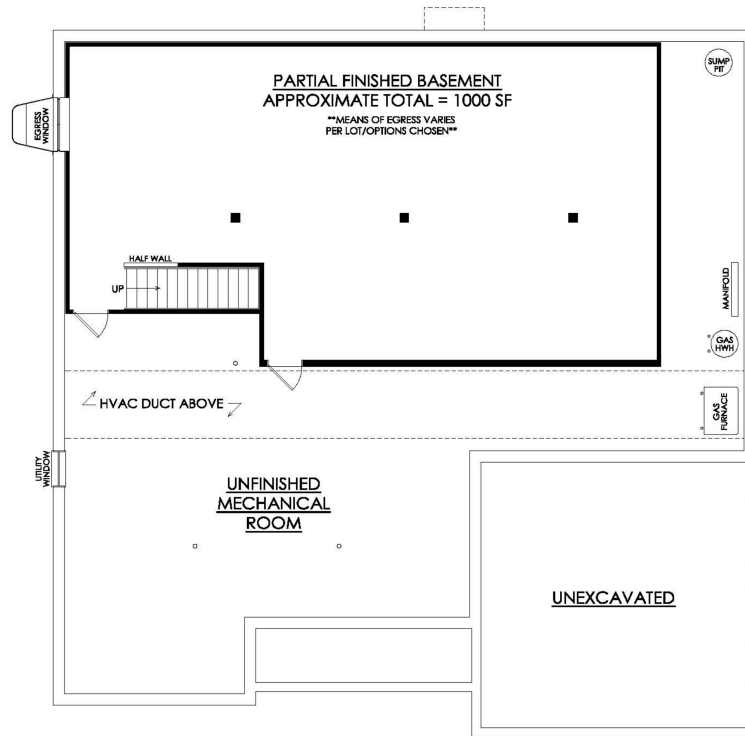

**FOLINO CRAFTSMAN**  
RIVERVIEW ESTATES  
STARTING AT 3134 SF

FINISHED BASEMENT